



3, 4,
5, 6

() 3, 4, 5, 6
(3, 4, 5) 6 2- 3
.364.215 .
3 (4- 7-)
.364.047 .
3 6
, -5 - , 4 -

.1.

.364.215 (.434410.104).

3(4,5,6)	4(7,10,19,32, 50)	1()	1(1...12)
1 -			
-			
-			
(3 10- , 19-)			

" " (« »),

3-10-1-1- .364.215
4-13-1-2- .364.215
5-32-1-2- .364.215
6-50- -7- .364.215

1

	3	4	5	6
	30	30	30	60

0,2 (2 / 2), 3⁻¹ (. .⁻¹)
 -
 , 200⁰ :
 ,







5000
 . .1
 200
 3 10⁻³ (3 10⁻⁵)
 250
 1000
 15

$\frac{1}{2}$ (g)	1-5000 600 (60)	, ⁰	100
		, ⁰	60
$\frac{1}{2}$ (g) :	10000 (1000)	, (. .)	1,34 10 ⁻¹⁰ (1 10 ⁻¹²)
$\frac{1}{2}$ (g)	2000 (200)		

200 ⁰ ,	, ⁰
1000	120
3000	102
5000	94
7500	88
10000	84
150000	78
200000	75
25000	72
30000	69
40000	65
50000	63
80000	57
100000	54
130000	51

, %	, ⁰
100	20
90	18
80	17
70	14
50	10
40	8
30	6
20	4

1

1	2	3	,		
			4	5	6
10		4	1,5	2	6
12		7			10
14		10			15
18		19	1,1		20
22		32	0,9		28
27		50	0,7		35

3

2

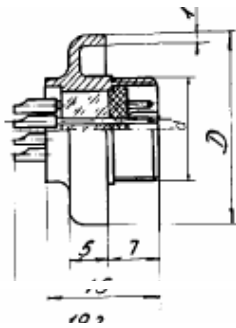

	d	D
3-4-1-1-	10 0,75	17,4
3-7-1-1-	12 0,75	19,4
3-10-1-1-	14 0,75	25
3-19-1-1-	18 1	29
3-32-1-1-	22 1	33
3-50-1-1-	27 1	38

4

3

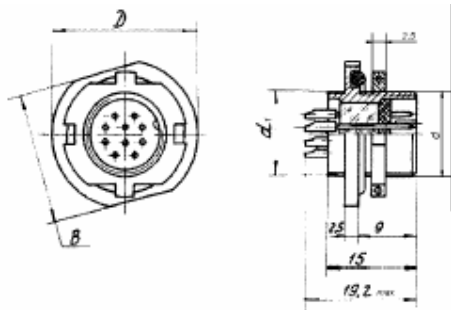

	d1	d	D	B
4-10-1-1-	14 0,75	14 0,75	25	22
4-19-1-1-	18 0,75	18 1,0	29	26
4-32-1-1-	22 0,75	22 1,0	33	30
4-50-1-1-	27 0,75	27 1,0	38	35

5

4

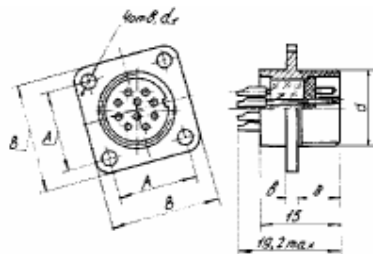

	d	d1	A	B	
5-10-1-1-	14	2,2	15	20	1,8
5-19-1-1-	18	2,7	18	24	2
5-32-1-1-	22	2,7	21,5	28	2
5-50-1-1-	27	3,2	26	33	2

6

5

