

**2 -**

() 2 - 3 ,
.2. 2 - 2 ,
.364.208
.364.126 .

1.

.364.208 .

2 -	42	50	2
:			
-			
:			
-			
-			
(2 - 1,0 1,5 .)			

« »,

:
:2 - 42 50 2 0.386.208

1

	1	1,5
	15	10
		5000
		. . 1
()		. . 1
168412 (1,7 / ²)		
-		500
,		5000
:		15

:	5-5000	, ⁰	100
, / ² (g)	588,6 (60)	, ⁰	60
:		, (.)	1,34 10 ⁻¹⁰ (1 10 ⁻¹²)
, / ² (g)	1962 (200)		
:			
, / ² (g)	1471 (150)		

200 ⁰ ,	, ⁰
5000	
	150
10000	135
15000	130
20000	125
25000	120
50000	110
100000	100

, %	, ⁰
120	80
110	65
100	50
85	40
75	30
60	25
50	20

2

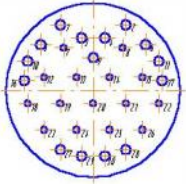
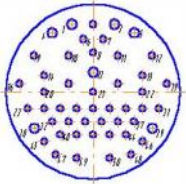
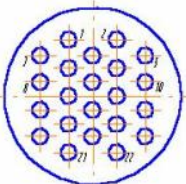
1	2	3	4	5	6	7	8	9	10
2	-		⊕	1,0	15	2,9	3,5	5,8	700
				1,5	15	5,75	7,0	11,5	560
			⊕	1,0	43	2,48	3,0	4,96	700
				1,5	7	5,0	6,0	10	560
	22		⊕	1,0	10	4,2	5	8,4	560

2 -

:

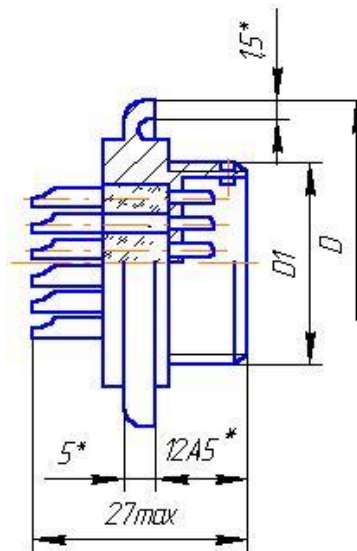

3

	D	D1
22	44	24 1
42	65	45 1,5